

The Rarest...



1ST TIME IN JAMNAGAR **4 BHK** BUNGLOWS
WITH **PERSONAL LIFT**

About Group



89 projects and 9,900 dreams have been getting fulfilled over these 39 years.

These figures resemble the lavish real estate legacy and pinch how much **HOME MAKER** is trustworthy as a brand. It is a very well derived fact that, if you try to give something good to the people from the heart, they too do not hold back in showering love and belongingness from the heart.

Thankfully we have been rejoicing this partnership for more than three and a half decades. To carry forward this relationship, we are ready to present **ASHWAMEGH ELEGANCE**

Ashwamegh Elegance

Special Features

Every bungalow is West Open

Every bungalow has private bore-well with pump

Every bungalow has its private lift first time in Jamnagar

Every bungalow has its private solar panel meter system, so no more too much bill for electricity

Kitchen is as per the vastu direction (south east - agni corner)

Every bungalow has five toilets in which one is common & rest all are attached with each room.

Facilities



Earthquake resistant & RCC frame structure bungalow with good quality masonry material.



Every bungalow breathes in full air & light with two side opens.



Marketable clear title & J.M.C. approved bungalow plan.



Beautiful & attractive elevation.



water proofing in balconies, roof slab & toilet sunk slab.

Master Piece With
The Ultimate Peace...



Ground Floor

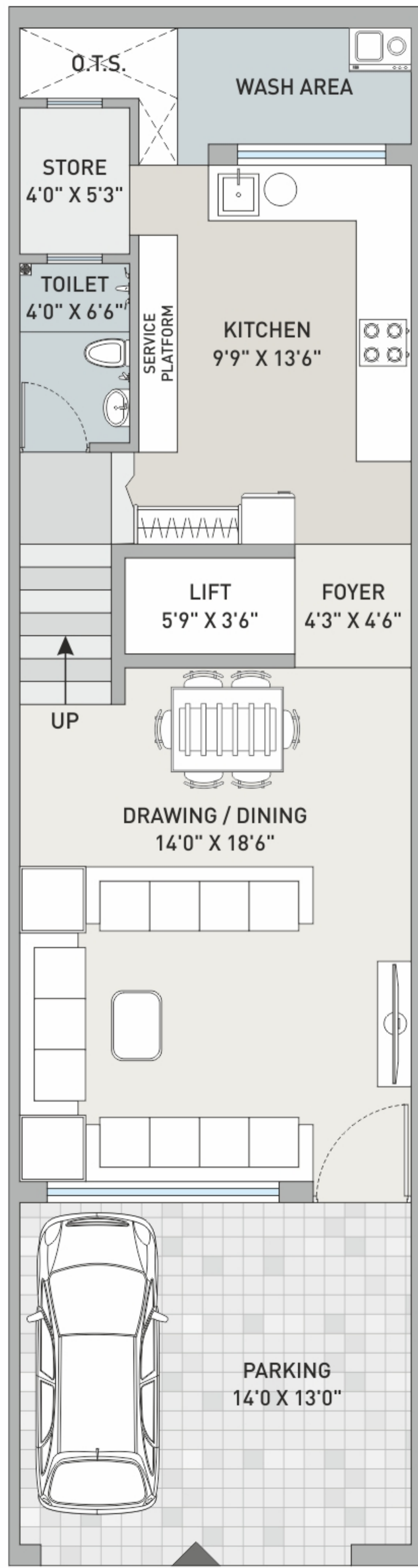

Section View



First Floor

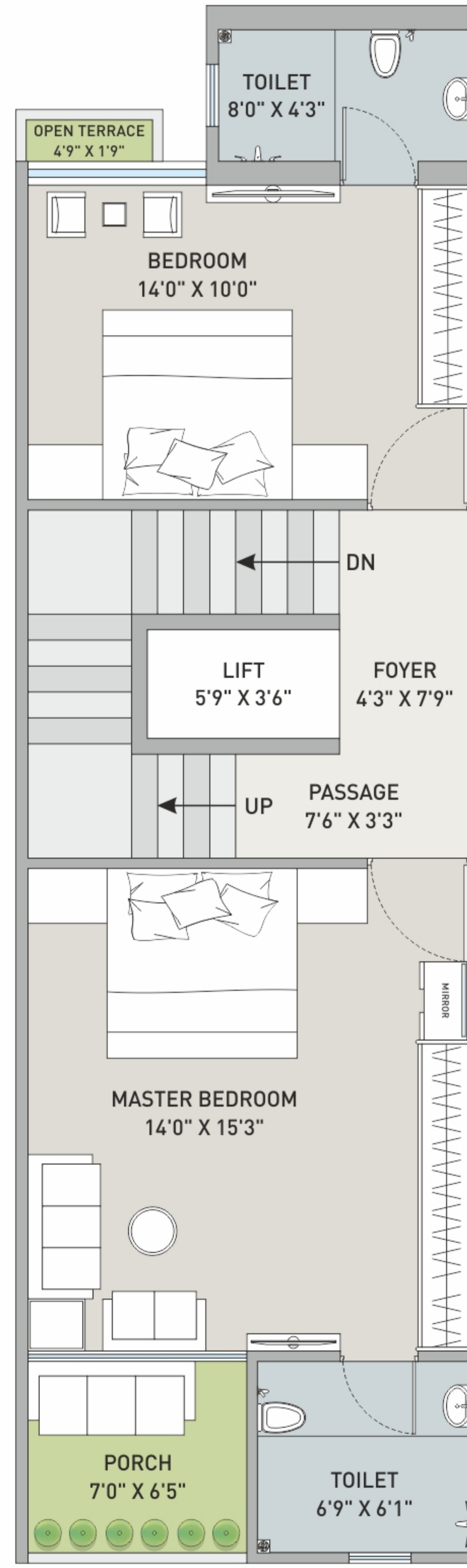

Section View



Second Floor

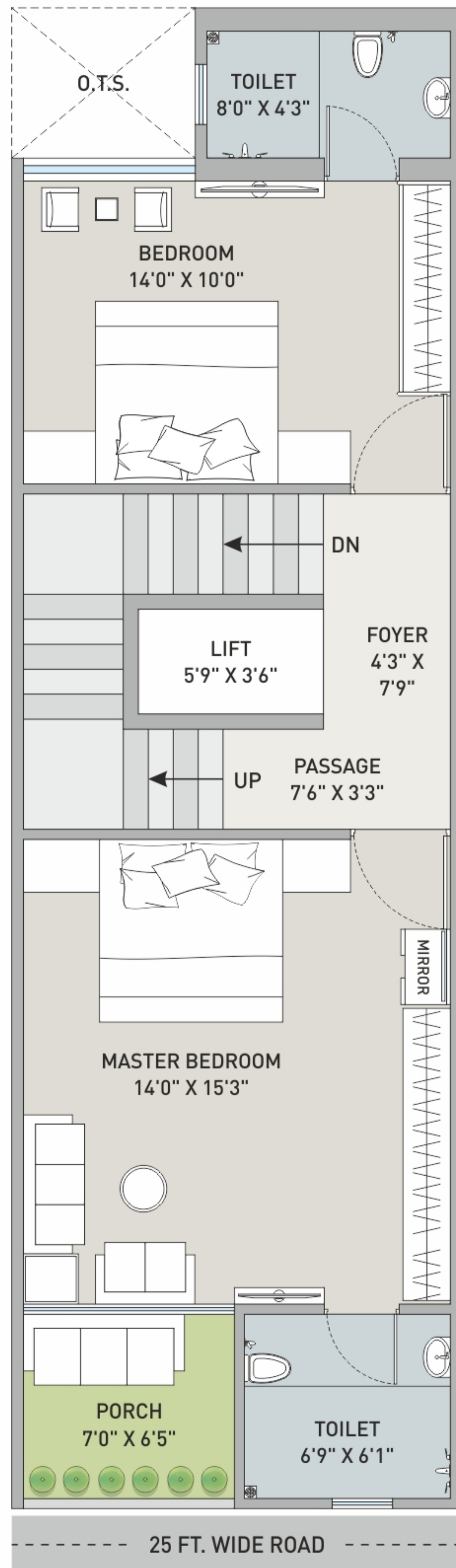

Section View



Homes are outdated,
Live In a 5 Star...



Layout Plan

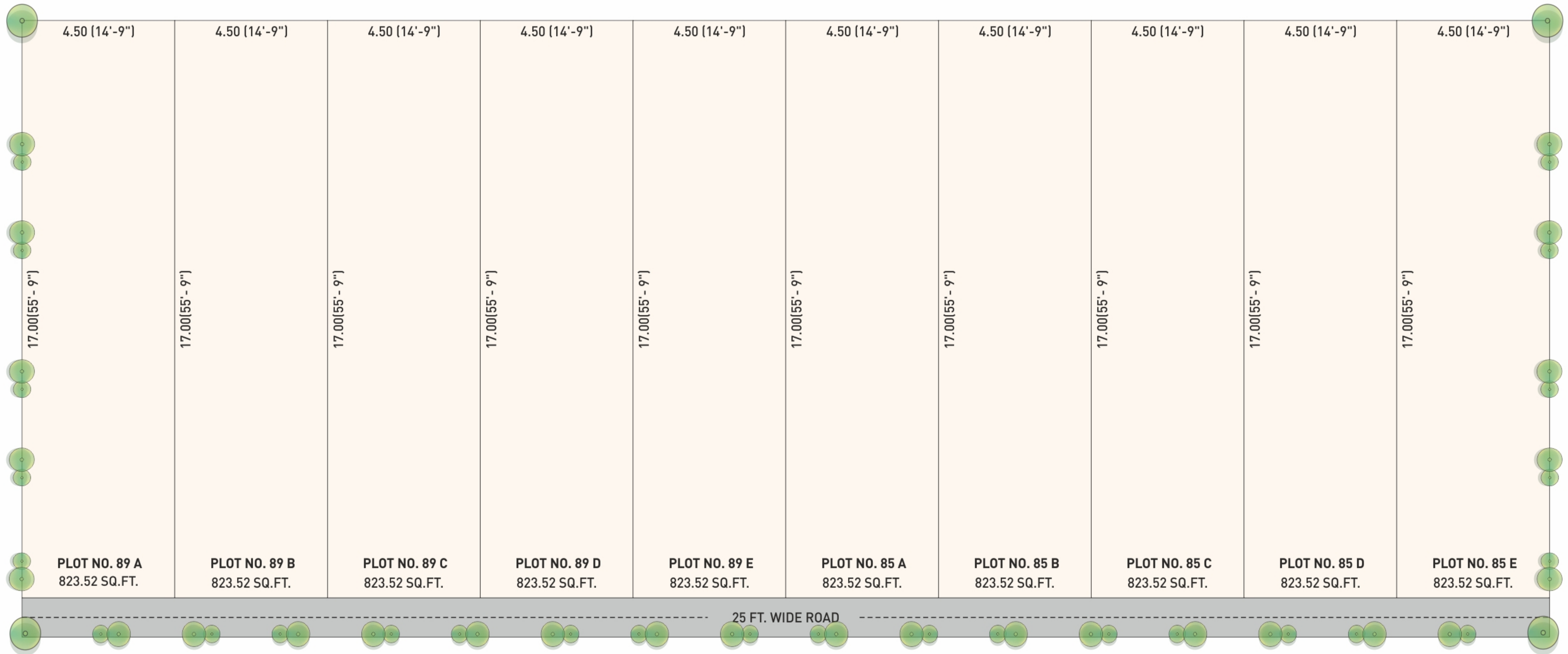

PLOT NO	PLOT AREA	BUILT - AREA
PLOT NO. 89 A	823.52 SQ.FT.	2502 SQ.FT.
PLOT NO. 89 B	823.52 SQ.FT.	2502 SQ.FT.
PLOT NO. 89 C	823.52 SQ.FT.	2502 SQ.FT.
PLOT NO. 89 D	823.52 SQ.FT.	2502 SQ.FT.
PLOT NO. 89 E	823.52 SQ.FT.	2502 SQ.FT.

PLOT NO	PLOT AREA	BUILT - AREA
PLOT NO. 85 A	823.52 SQ.FT.	2502 SQ.FT.
PLOT NO. 85 B	823.52 SQ.FT.	2502 SQ.FT.
PLOT NO. 85 C	823.52 SQ.FT.	2502 SQ.FT.
PLOT NO. 85 D	823.52 SQ.FT.	2502 SQ.FT.
PLOT NO. 85 E	823.52 SQ.FT.	2502 SQ.FT.



Specifications

FLOORING

- Premium quality vitrified in drawing, dining, Kitchen & bedrooms.
- China mosaic flooring on terrace floor.

KITCHEN, WASH YARD & STORE

- Fully Glazed tiles up to slab level.
- White nano / black granite platform with S.S. Sink.
- Ample electric point for mixer, juicer, microwave, etc.
- Provision for R.O. Plant & Washing Machine in wash area.
- Glaze tiles in washing area & anti - skid tiles in flooring.
- Provision for chimney point on main platform.
- Fully glazed tiles in store area.
- 3 rows of shelves in store for storage - kota stone.

PLUMBING

- C.P.V.C. pipes for water supply & P.V.C. pipes for soil, drainage & waste system.

WINDOWS

- All windows aluminium section & domel section & UPVC.
- Fully glazed with granite / marble sill.
- All windows with safety M.S. Grills.

DOORS

- Decorative laminated / modular main entrance door with lock system of branded company.
- Modular door or laminated doors with wooden / granite / marble door frames in all internal openings.
- All doors with necessary hardware fitting of well known brand.

POWER BACKUP

- Internal electric wiring of inverter will be provided.
- Special inverter point will be there to keep inverter.

BATHROOMS

- One Common & four attach toilet, total 5 bathrooms.
- Fully glazed tiles up to slab level.
- Standard quality sanitarywares.
- Standard quality plumbing fittings.
- Exhaust fan provosion.
- Provision for electric geyser point.

SECURITY

- Video door phone in each bunglow.
- CCTV camera surveillance at entrance of the bunglow & at the entrance of the terrace.

LIFT

- 2 & 3 - passenger lift for private use.

ELECTRIC

- Branded modular switches.
- Premium quality ISI copper wiring with ample no. of points.
- T.V. / Telephone / AC etc, points in drawing, dinning & bedroom.
- Concealed wiring of well known brand.
- Provided basic holes for outlet units of split AC fitting in all bedrooms & drawing room.

PLASTER & COLOR

- Internal plaster with acrylic putty finish.
- Sand face plaster on exterior surface of building.
- Acrylic emulsion paint on exterior walls.

Note. :

- Payment of all extra work to be executed shall be made in advance. • Stamp duty towards registration shall be borne by the client.
- Municipal corporations & GEB charges, if any, shall be borne by client. • Any central or state govt. taxes, if applicable shall have to borne by the clients.
- All members shall have to essentially be the part of the society formed by the Association. • Irregular payments may lead to cancellation of bookings and late payment will be charged. • Legal documentation charges shall be borne by clients of members & shall abide by the society by - laws.

•The information contained in this brochure is indicative of the kind of development that is proposed. It is prepared & issued in good faith and is for guidance only. It dose not constitute part of an offer or contract. Subject to the approval of the authorities of in the interest of the continuing improvement, the promoters reserve the rights to change plans, No. of storeys, specifications of features without prior notice of obligation. Guidelines are enforced for not allowing grills, flower pots etc. to be fixed outside windows or any changes to be made in external elevation. All the images are just for idealization.

Structure Engineer



Somil Khattar
98796 44646

Architect



UTTAM ART
Kirtibhai Zaveri

Legal Advisor

Punit Mehta
94277 75707

Way to Your Home

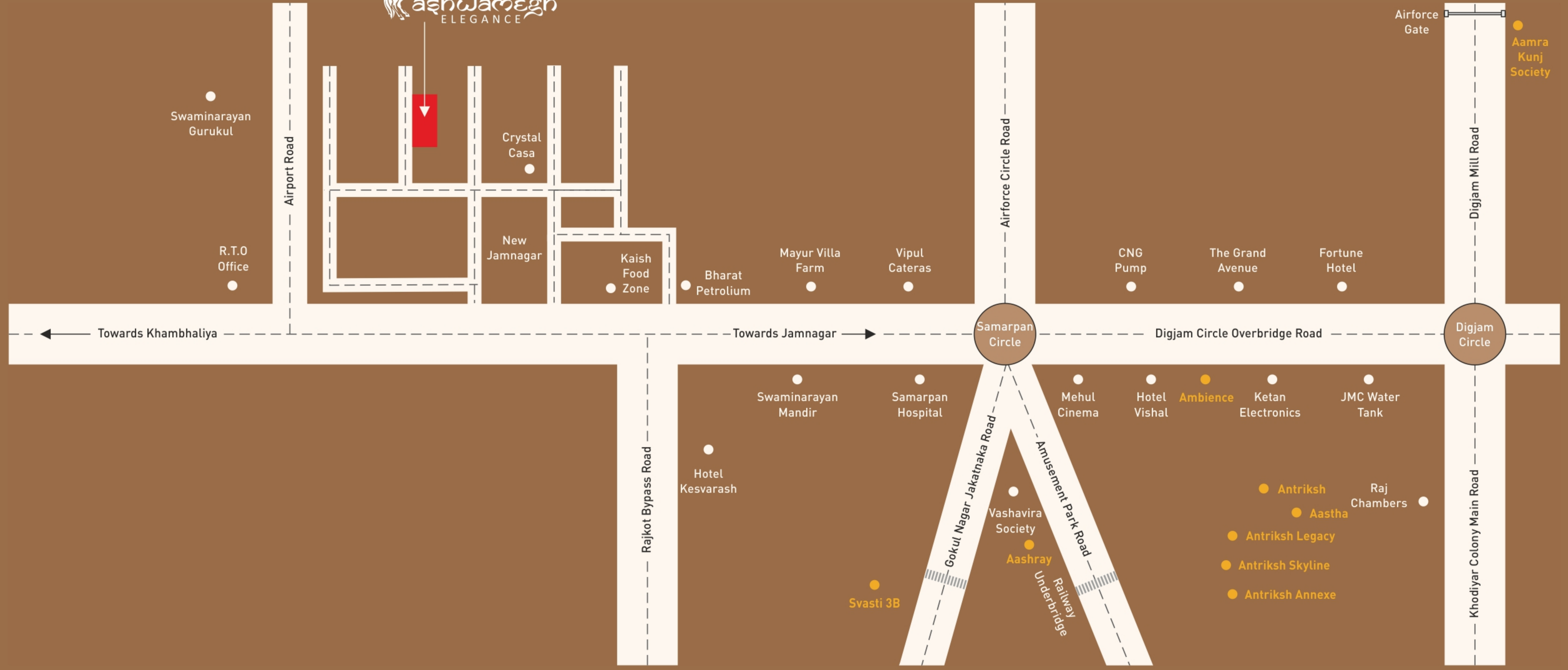

New Jamnagar, Geetanjali Park-3,
Nr. Bypass Chowkdi, Reliance Highway, Jamnagar.



A Project By



Builders & Developers

Dhimant Shah | Divyesh Shah

Nishith Shah

97148 15158 | 81609 13335

 www.homemaker.in  homemaker_1982@yahoo.com