

Antriks'n
legacy

2 & 3 BHK
FLATS & SHOPS
A RERA REGISTERED PROJECT



WAY TO A WORLD
OF PEACEFUL LIVING



ANTRIKSH LEGACY

THE PREMIUM CLASS ADDRESS FOR WORLD CLASS LIVING

WE LIVE IN A TIME WHERE COMFORT AND LUXURY ARE OF THE UTMOST IMPORTANCE AND AT ANTRIKSH LEGACY, WE COMBINE THESE TWO AND GIVE YOU A HOME THAT IS PERFECT FOR YOUR FAMILY.

- GRAND TOWER WITH 7 STOREYS WITH EACH AND EVERY FLAT ROAD FACING !!!
- 2 & 3 BHK LUXURIOUS RESIDENCES
- LOCATED IN A PREMIUM AREA OF JAMNAGAR
- WALKABLE DISTANCE FROM LEADING INTERNATIONAL SCHOOL, DERASAR & TEMPLES
- NEAREST TO ONE AND ONLY AMUSEMENT PARK OF THE CITY
- MULTIPLEXES, RESTAURANTS, WELL KNOWN SCHOOLS & GIANT COMPANIES LIKE RELIANCE & NAYARA'S PICKUP - DROP POINT ARE JUST IN 1 KM DISTANCE
- AIRPORT : 5KM, RAILWAY STATION : 6 KM, HOSPITAL : 2 KM ONLY

11 Shops

35 Flats



FIND PEACEFUL MOMENTS
AMIDST NATURE TO SOOTHE YOUR SOUL



PLAN FOR A HAPPY
EXITING FUTURE !



જે દરેક અર્થમાં છે પરિપૂર્ણ.
જે દરેક અર્થ માં છે પરીપૂર્ણ પ્રકૃતિની નજીક મળો એક અદભુત જીવન



TAKE YOUR FIRST STEP
INTO A LIFE OF LUXURY



તમારા જીવનની ભવ્યતા માં ઉમેરો એક એવું ઘર
જે તમારા મનને ખુશ કરશે





YOUR SEARCH FOR THE PERFECT

જો તમે શોધતા હો એક સુખી, સમૃદ્ધ ઘર,
તો આવો અને અનુભવ કરો તમારા સપનાનું ઘર.

PERFECT LOCATION WITH EXTRAORDINARY CONNECTIVITY

જામનગરના દરેક મેઇન રોડની નજીક,
આ લોકેશન છે તમારા માટે એકદમ પરફેક્ટ.

Basement Floor Plan

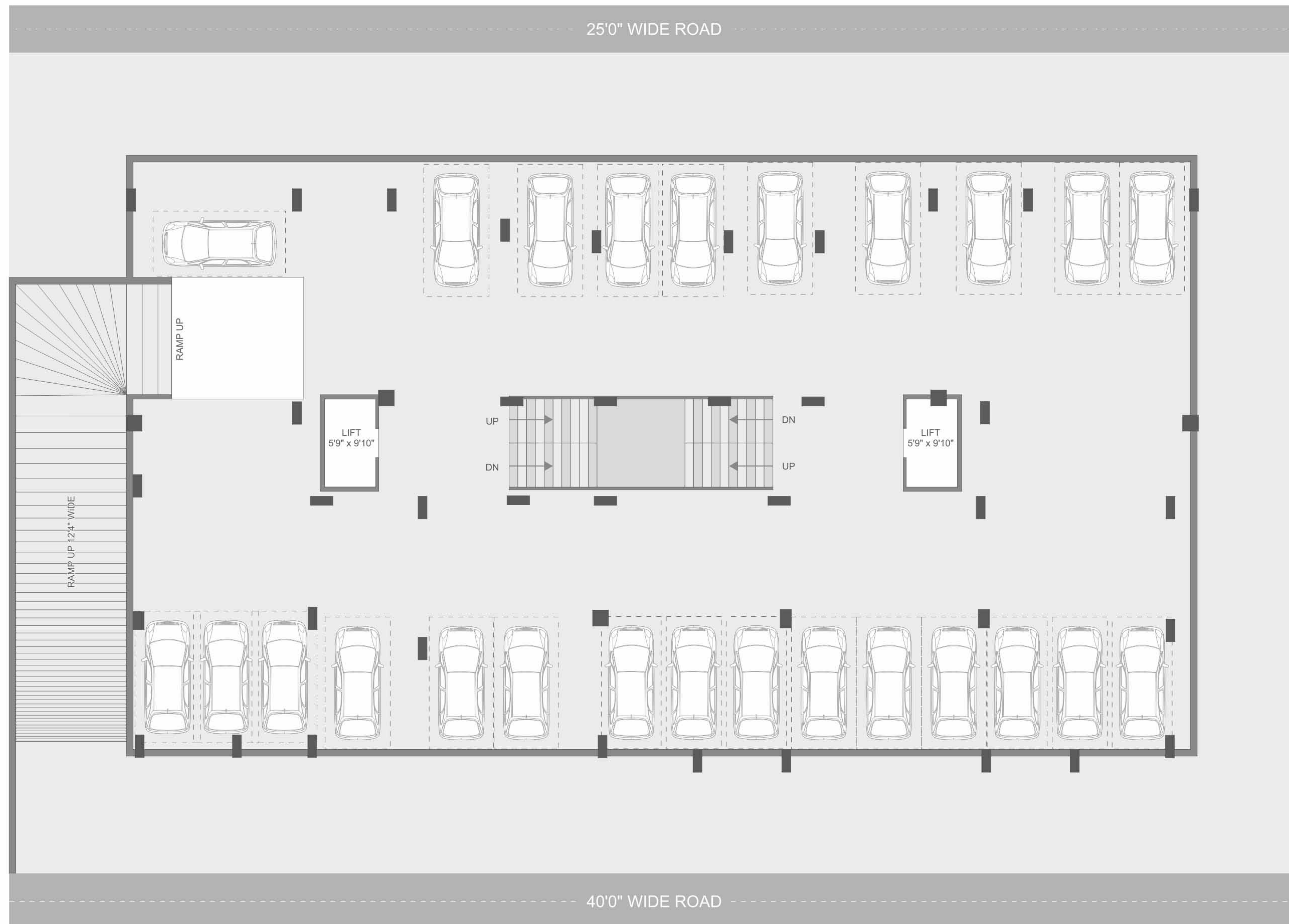

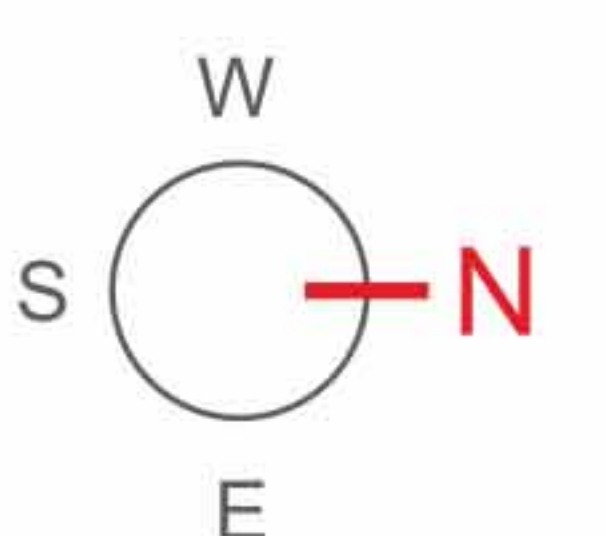



2nd to 7th Floor Plan

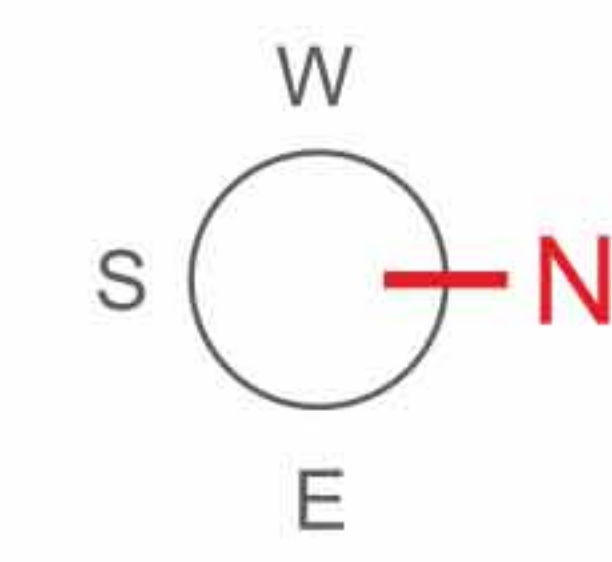

GIVE YOURSELF THE GIFT
OF A HAPPY AND SAFE FUTURE



તમારા કુટુંબને એક અનોખી ભેટ આપો.
એક એવું ઘર જે રાખે તમને સુરક્ષીત



THE LUXURY OF LIVING IN AN ELEGANT HOME
TO LIVE A PERFECT LIFE

તમે ડીઝર્વ કરો છો જીવન માં
ફક્ત સર્વશ્રેષ્ઠ વસ્તુઓ



Special Features

- **ALLOTTED CAR PARKING FOR EACH & EVERY FLAT.**
- **PERSONAL OVER-HEAD WATER TANK FOR EACH FLAT.**
- **CHILDREN PLAY AREA AT GROUND FLOOR.**
- **COMMON GARDEN & SENIOR CITIZEN SITTING AREA AT GROUND FLOOR.**
- EARTHQUAKE RESISTANT & RCC FRAME STRUCTURE BUILDING WITH GOOD QUALITY MASONRY MATERIAL.
- EVERY FLAT BREATHS IN FULL AIR & LIGHT WITH TWO SIDE ROAD OPENINGS.
- MARKETABLE CLEAR TITLE & J.M.C. APPROVED BUILDING PLAN.
- BEAUTIFUL & ATTRACTIVE ELEVATION.
- COMMON TOILET AT GROUND FLOOR.
- ATTRACTIVE NAME PLATE OF FLAT OWNER'S AT GROUND FLOOR.
- AMPLE PARKING SPACE AT GROUND FLOOR & BASEMENT.
- WATER PROOFING IN BALCONIES, ROOF SLAB & TOILET SUNK SLAB.

Amenities

Flooring

- Premium quality vitrified in drawing, dining, kitchen & bedrooms. China mosaic flooring on terrace floor

Kitchen & wash yard

- Fully glazed tiles up to slab level
- Black granite platform with S.S. Sink
- Ample electric point for mixer, juicer, microwave etc.
- Provision for R.O. Plant & Washing Machine in wash area
- Glaze tiles in washing area & anti-skid tiles in flooring
- Provision for chimney point on main platform

Plumbing

- C.P.V.C. Pipes for water supply & P.V.C. Pipes for soil, drainage & waste system

Windows

- All windows will be three track aluminum section
- Fully glazed with granite / marble sill
- All windows with safety M.S. Grills

Entrance

- Attractive entrance foyer
- Entry & Exit of building with camera surveillance

Doors

- Decorative laminated / modular main entrance door with lock system of branded company
- Modular door or laminated doors with wooden / granite / marble door frames in all internal openings.
- All doors with necessary hardware fitting of well known brand

Power backup

- Automatic generator of well known company for Lift, common area lighting & Pumps

Bathrooms

- Fully glazed tiles up to slab level
- Standard quality sanitarywares
- Standard quality plumbing fittings
- Exhaust Fan provision
- Provision for electric Geyser point

Security

- Video door phone in each flat
- Intercom facilities to talk with watchman & other flat members

Lift

- Automatic opening auto door 2 lifts

Electric

- Branded modular switches
- Premium quality ISI copper wiring with ample no. of points.
- T.V. / Telephone / AC etc, points in Drawing, Dinning & Bedroom.
- Concealed wiring of well known brand.
- Provided basic holes for outlet units of split AC fitting in all Bedrooms.

Plaster & color

- Internal plaster with acrylic putty finish
- Sand face plaster on exterior surface of building
- Acrylic emulsion paint on exterior walls

WAY TO YOUR HOME.....



RERA No.: PR/GJ/JAMNAGAR/JAMNAGAR/Others/MAA05137/260319

Web : www.gujrera.gujarat.gov.in

Note :

- Payment of all extra work to be executed shall be made in advance.
- Stamp Duty towards registration shall be borne by the client.
- Municipal corporations & GEB charges, if any, shall be borne by client.
- Any central or state govt. taxes, if applicable shall have to borne by the clients.
- All members shall have to essentially be the part of the society formed by the Association.
- Irregular payments may lead to cancellation of bookings and late payment will be charged.
- Legal documentation charges shall be borne by clients of members & shall abide by the society by-laws.

The information contained in this brochure is indicative of the kind of development that is proposed. It is prepared & issued in good faith and is for guidance only. It does not constitute part of an offer or contract. Subject to the approval of the authorities in the interest of the continuing improvement, the promoters reserve the rights to change plans, No. of storeys, specifications of features without prior notice of obligation. Guidelines are enforced for not allowing grills, flower pots etc. to be fixed outside windows or any changes to be made in external elevation. All the images are just for idealization.



Builders and Developers :

Dhimant Shah | Divyesh Shah
Nishith Shah

☎ 9714815158 ☎ 81609 13335

Architect:
Uttam Art

Structure Engineer:
Nirman Associates

E-mail : homemaker_1982@yahoo.com

Web : www.home-maker.in

A Project By:



Site Address : "Antriksh Legacy", Next To Swami Tower, Beside Antriksh Annexe, Mehul Nagar, Opp. Shreeji Hall Lane, Jamnagar.